

4-14-9

4

40 - Noak 18" for cor.
79.74 - { 509.10" S 81° E 31.02
 { 110.15" N 74° W 16.5
INT. N. B. D. 42.24' W. of Post.

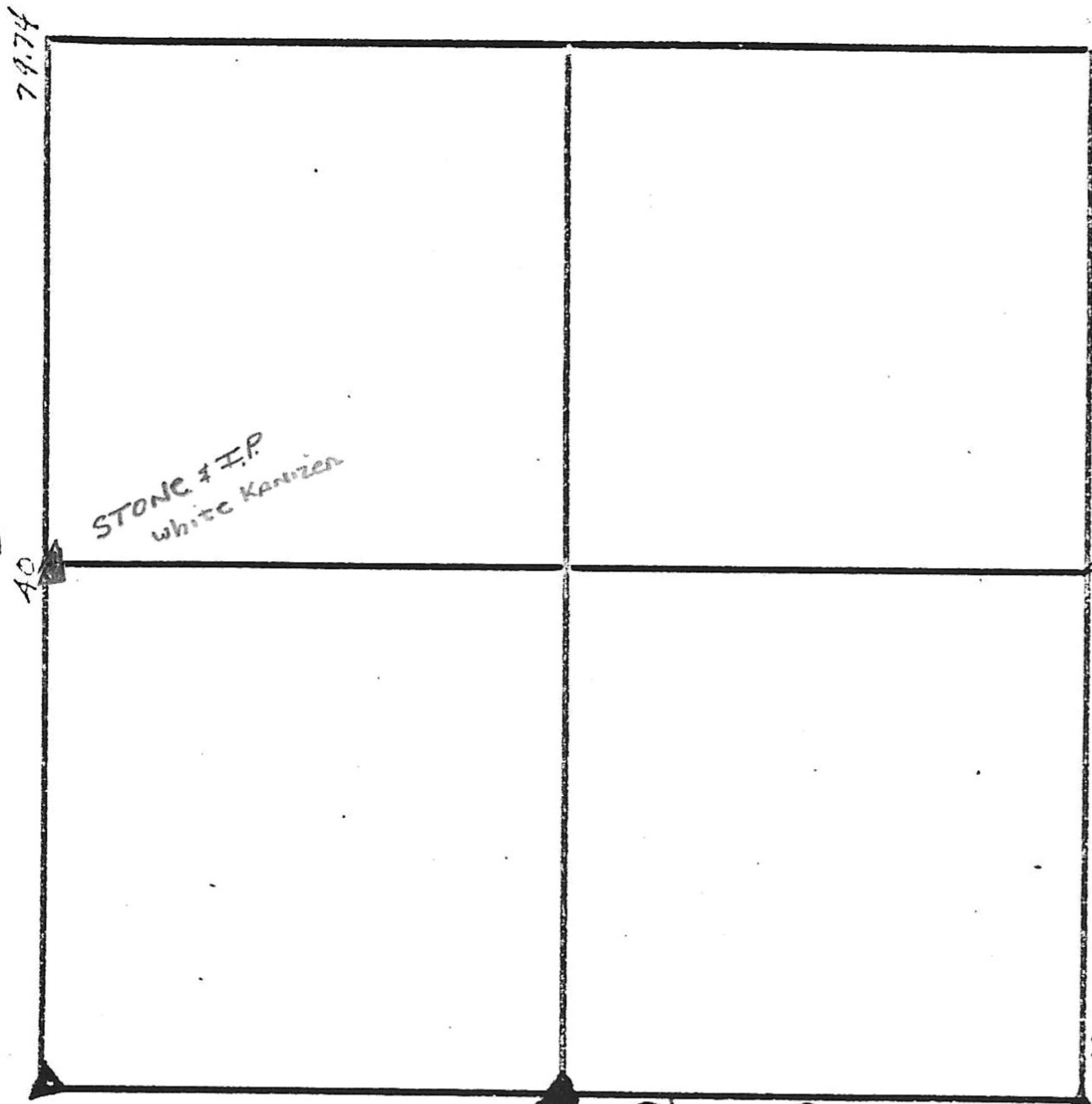

see ties
3-14-9

2 Stone found @ E road on line
with fence running South
(977.65' East to East side Johnson Str)

see
Sunnyside
subd. Pl 67

(over)

Found by MBP Jainwala Park
" " Dred Bank "

w-51 notes
MBP w-52

Stone at SE Cor. of 4-14-9 is 27' So. of
N. Line of 4th St. (CHH) (1947) (see STR. File for Ties)