

BOOK IN IRVY TRACTORS OFFICE AT CLINTON MO.

1971

STONE - N.E. COR. SEC. 9-14-9W:

39' N.W. to Cop s_rew in Walk at S.E. Cor of Gosnell Store.

39.45' N.E. to $\frac{3}{4}$ " pipe at inside edge of walk intersection.

30.62' to center of bolt at top of fire hydrant at the S.W. cor of street intersection, 4th & Washington or 9th.

STONE - shown at center of Section - no ties.

1 $\frac{1}{8}$ " Iron Rod - S.E. COR. SEC. 9-14-9W:

48.5' S.E. to N.W. Cor Brick Bldg.

62.38' N.E. to S.W. Cor. Lumber yd. office.

35.42' S.W. to center of bolt at top of fire hydrant.

46.71' S.W. to N.E. Cor of Brick bldg. at S.W. Cor. of 9th & Knowles.

36- Brick 7' NE
 55.5 " 10' E
 40- { Bench 36" N 32 E 13.7
 W: 11.1 6" S 22 W 55.44
 80- { W: 0.0 12" S 72 W 16.5
 " 30" S 84 E 52.44

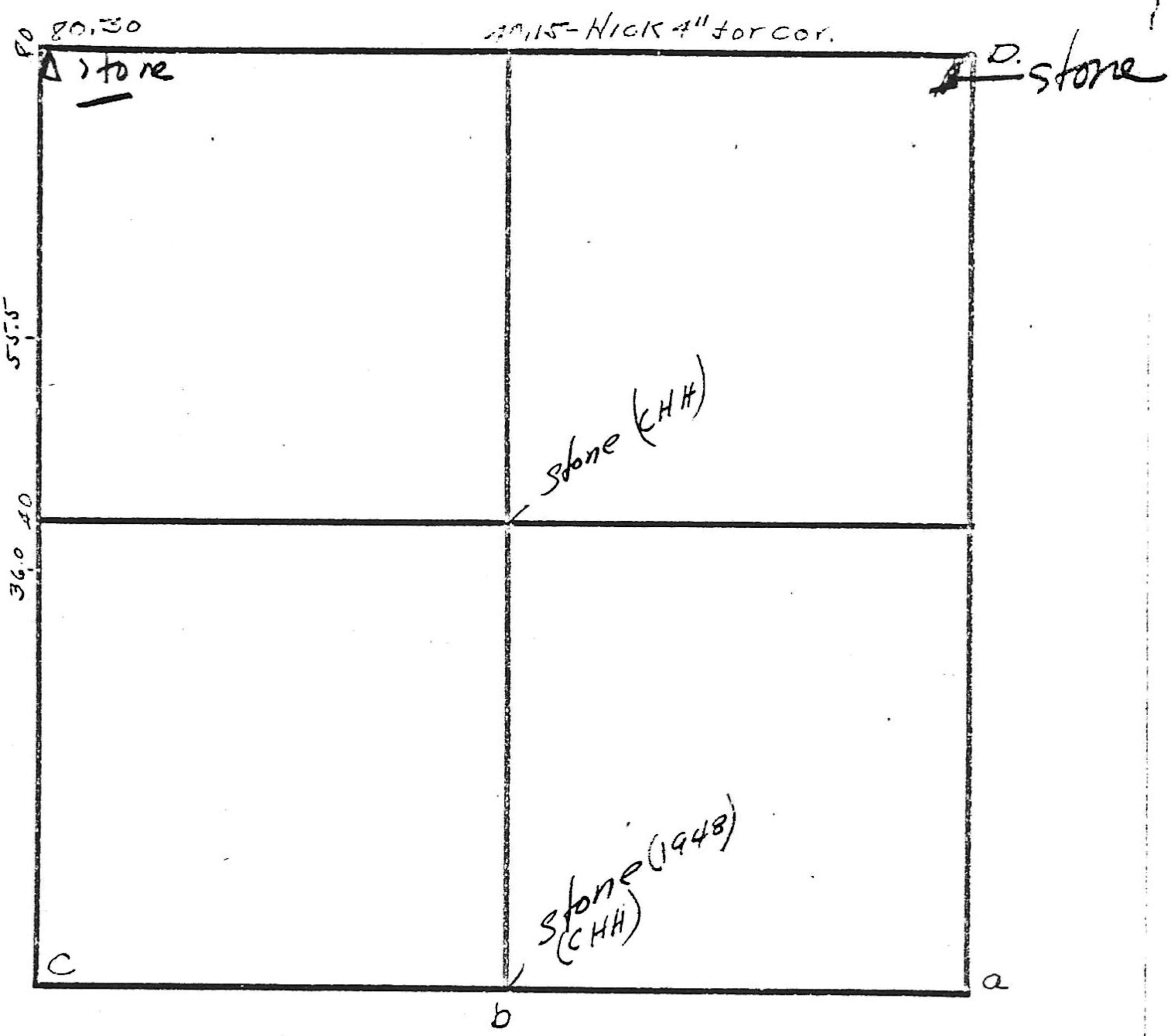

a. - Granite Stone x Stone N 32 E 36.76
 Stone S 32 W 34.96

b. - Stone x Sandstone E. 21.78
 Sandstone W. 27.06

Mar. 29. 1890. - 71. 4. 7. 1. 1. 1.

c. Look for stone.

D. Stones - { Copper screw in walk. N.W. cor. 39'
 Inside edge sidewalk intersection N.E. cor. 39'
 (1/8") - 1966

Iron Pin at SE Cor Sec 9 (3/4" Rod)
 Ref. 62.65 NE to SW cor Wilkinson Lumber Co Office
 (Parrett has 59.65 in his 1921 book)
 48.50 SE to NW cor of Brick Bldg, (Tavern) @ SE Cor 9th
 & Knowles
 46.71 SW to NE cor BRICK BLDG at SW cor 9th & Knowles
 35.42 SW to center of bolt at top of Fire Hydr.

Sweethy RAP
 " " " Claude Matthews 3/29/90?
 " " " Am _____
 " " " MBP - Jim Buffa add
 " " " In Buckley add?
 " " " Lot 1 Buckley
 " " " Pete Buffa E35' 100' 9"
 " " " Paul Kleister Lot?

_____ H21

P-19 P6

" " " _____ E29
 " " " Javineu Park E92
 " " " Sunnyside? Sub E86
 " " " Knowles Hts add E104

Information

" " " C. E. & D. Key Ave E110
 " " " Lot 2 Blk 12 - Clinton

CECIL HARRISON (1922 Book)

Stone @ NE Cor 9-14-9
 Ref. 39' NW to Cap Screw in
 sidewalk near SE Cor. Cronell's Store
 39.35' NE TO ^{AS} _{INSIDE} edge of sidewalk
 intersections at SW cor School House

30.62 SW to center of Bolt @ Top of Hy. Mast.

SE Cor 9-14-9
 To Lumber Yard: 62.25'
 To cor BLD SE cor 48'

M. E. MOEG ~ 1918 Book

Stone @ NW cor $\frac{1}{2}$ mile west (2676, 9 between stones)

wit. To Wilkenson Lumber Co. Bldg. 59.65
 To Bldg on S.E. Cor. 48.55
 N. to S. rail 2nd Track 4.9
 S to N. rail S. Track 3.0
 Tracks N. 10.45, 17.35, 30.38

NE Cor 9-14-9
 39' NW to Cap Screw
 in S.W.

Ninth & Western
 "X" in concrete, w/ 5th BCK N of alley
 S38°20'E - 39'

X - in E Cor.
 4th S. of Hwy
 S45°48'W. 39.1