

25

45
 40
 35
 30
 25
 20
 15
 10
 5

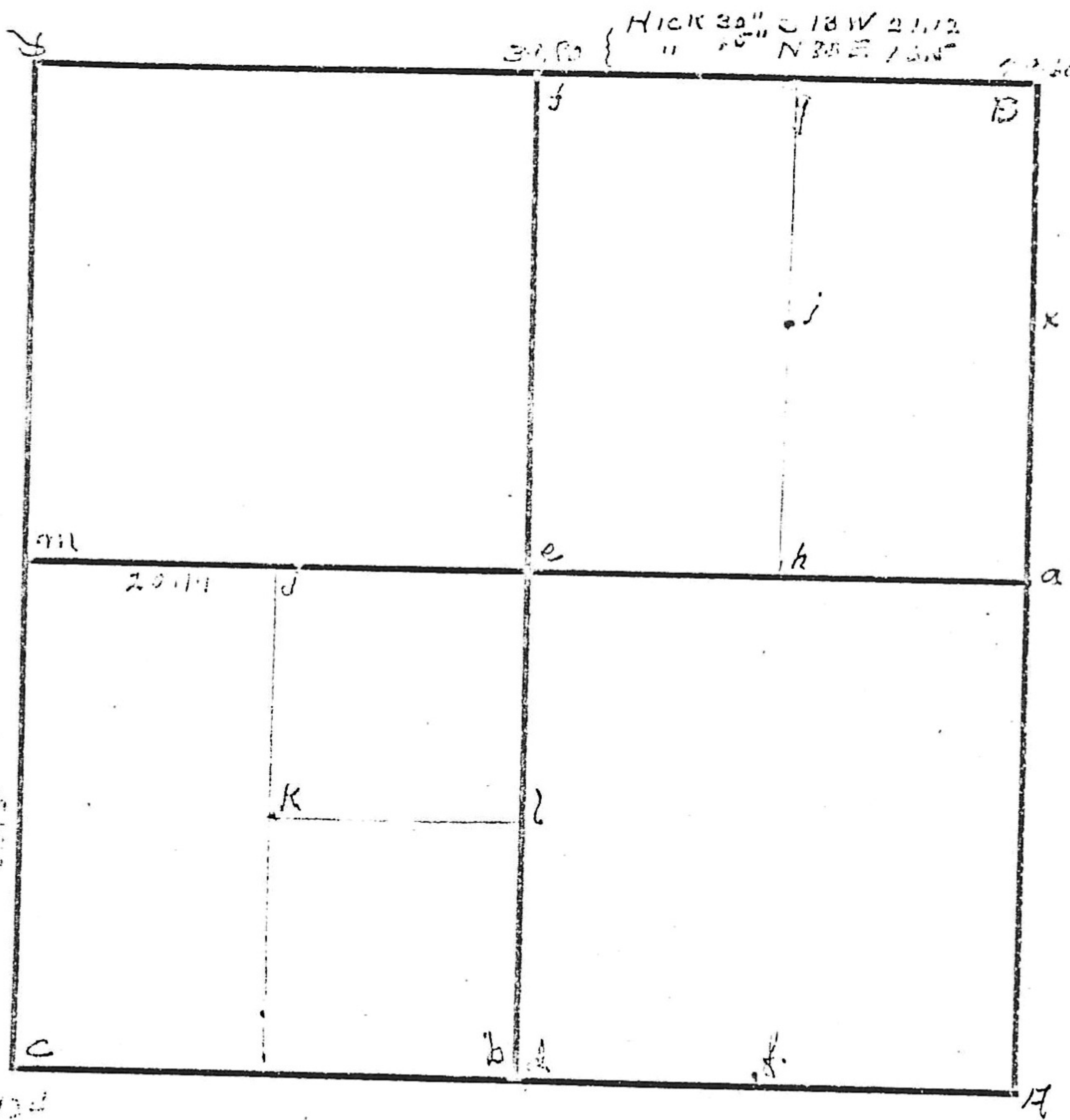

f-Original { Hick 30" S 18 W 21.12
 " 15" N 35 E 13.15
 d-Original { W. Oak 15 N 60 W 13
 B. Oak 8 N 23 E 29
 x-Original { Poplar 14 S 60 W 16
 " 8 S 80 E 24
 y-Original { Sugar 6 S 60 W 24
 Lynne 7 S 21 E 25

d-g - 20-10
 e-d - 40-15
 g-h - 40-96
 l-a - 40-40
 e-l - 20-20
 j-m - 20-20
 C-D - 80-57
 C-m - 40-43
 m-w - 40-48

b - Stone
 e - Stone { W. O. 8" N 76 E 21
 S 88 2" N 48 15 W. 2
 g - Stone { W. Hick 5" West.
 B. Walnut 12" N 80 45' E 54
 h - Stone - W. Oak 30" S 89 30' E 49
 j - Stone { Pop 12" S 19 30' E 1100'
 Fr. Oak 15" S 55 30' W. 119
 k - Stone - B. Walnut 30" South 33
 l - Stone { B. Oak 7" N 7 25' E 33
 Sugar 4" N 48 0' 15' W 2

Ret # 10
 d - { W. Oak 11 N 30 E 5
 W. Oak 14 N 41 W 112



P-10
Surety Inst Recd 1883