

VERMILLION COUNTY, IND. "MONUMENT RECORD"

OF

LAND SURVEY MONUMENTS SITUATED IN SECTION 10, TOWNSHIP 14N,

RANGE 9W, OF THE 2 PRINCIPAL MERIDIAN,

COUNTY, INDIANA

MONUMENT DESCRIPTION AND REMARKS: Nail Found NW corner
From: Yellow Hard Back Field Book By: John V. Major pg 4 (back of)
see: Gray File Cabinet Drawer #2 1989 Lietz

RECOVERY TIE DRAWING

Nail

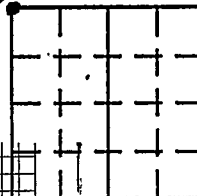

NORTH 2
(NOT TO SCALE)

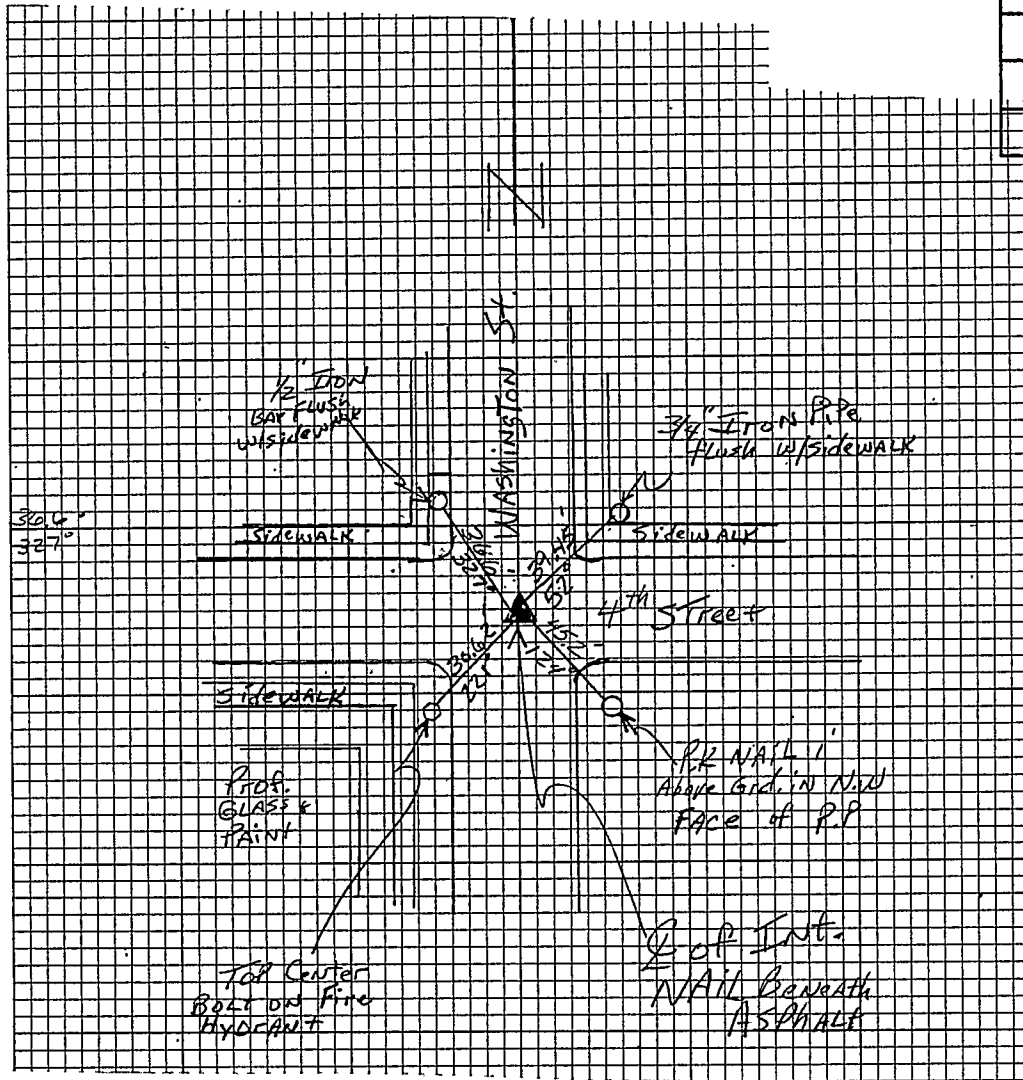

STATE OF _____

COUNTY OF _____ SS:

I, _____, HEREBY
 CERTIFY THAT THIS DOCUMENT WAS PREPARED
 UNDER MY DIRECTION IN ACCORDANCE WITH
 IND. CODE 36-2-12-11-(D)-(3) AND THE ABOVE
 DATA IS GIVEN UNDER MY HAND AND SEAL

THIS _____ DAY OF _____, 19 _____ A.D.

INDIANA REGISTERED LAND SURVEYOR NO. _____

OR _____
 UNITED STATES GOVERNMENT AGENCY

TITLE _____

SPACE RESERVED FOR
 RECORDING OFFICER

DATE FILED _____

