

VERMILLION COUNTY, IND. "MONUMENT RECORD" OF

LAND SURVEY MONUMENTS SITUATED IN SECTION 17, TOWNSHIP 14 N.
 RANGE 9 W., OF THE 2ND PRINCIPAL MERIDIAN, VERMILLION
 COUNTY, INDIANA

MONUMENT DESCRIPTION AND REMARKS: FOUND IRON PIN AT W 1/4
CORNER AND FOUND PK. NAIL AT SE 1/4 - NW 1/4
NW 1/4

RECOVERY TIE DRAWING

NORTH
(NOT TO SCALE)

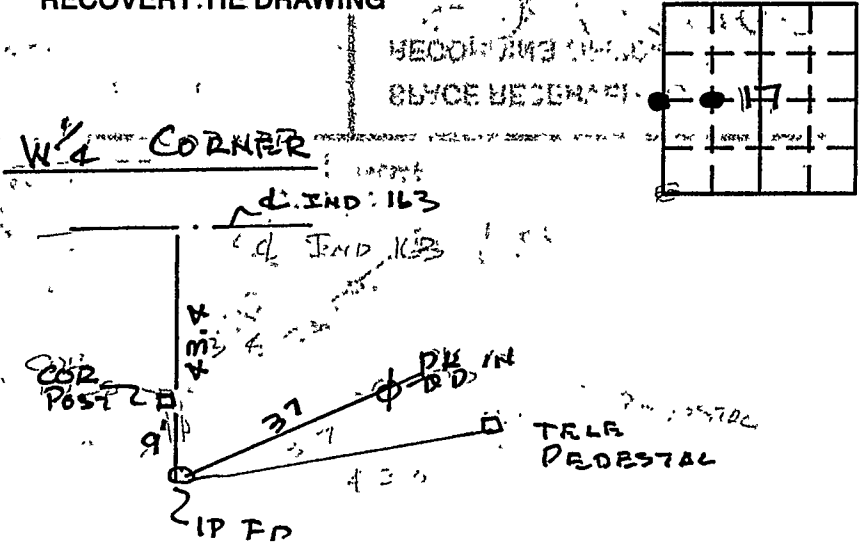

SE CORNER 2 1/2 W 1/4 NW 1/4

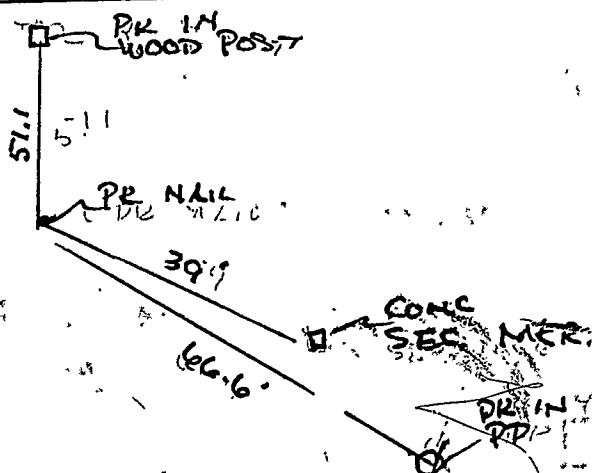

SURVEY RECORDED IN
 SURVEYOR'S OFFICE
 VERMILLION COUNTY INDIANA
 SURVEY RECORD BOOK # 1
 PAGE # 1 DATE 11/29/93
 CO. SURVEYOR John Mayo

STATE OF ILL
 COUNTY OF EDGAR SS

I, CHARLES J. BECHER, HEREBY
 CERTIFY THAT THIS DOCUMENT WAS PREPARED
 UNDER MY DIRECTION IN ACCORDANCE WITH
 IND. CODE 36-2-12-11-(D)-(3) AND THE ABOVE
 DATA IS GIVEN UNDER MY HAND AND SEAL

THIS 9 DAY OF JUNE, 19 93 A.D.

Charles J. Becher
 INDIANA REGISTERED LAND SURVEYOR NO. 6094

OR _____
 UNITED STATES GOVERNMENT AGENCY

TITLE

SPACE RESERVED FOR
 RECORDING OFFICER
John Mayo
 DATE FILED: 11/29/93

