

VERMILLION COUNTY, IND. "MONUMENT RECORD" OF

LAND SURVEY MONUMENTS SITUATED IN SECTION 21, TOWNSHIP 15 N,
RANGE 10 W, OF THE 2ND PRINCIPAL MERIDIAN, VERMILLION
COUNTY, INDIANA

MONUMENT DESCRIPTION AND REMARKS: FOUND RR SPIKE AT SE
CORNER AND SET 3/8" x 30' IRON PIN AT E 1/4
CORNER.

RECOVERY TIE DRAWING

NORTH
(NOT TO SCALE)

E 1/4 CORNER

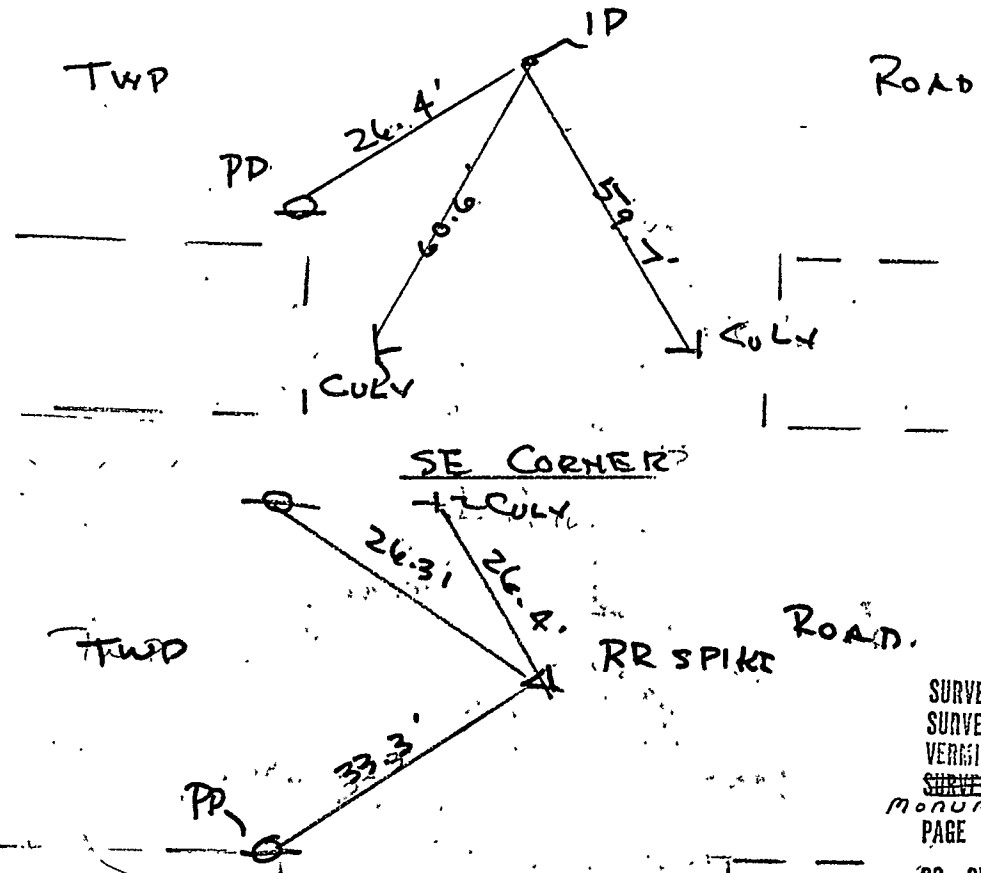
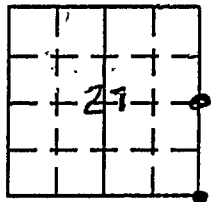

SURVEY RECORDED IN
SURVEYOR'S OFFICE
VERMILLION COUNTY INDIANA
SURVEY RECORD BOOK # 1
PAGE # 18 DATE 1/13/95
CO. SURVEYOR John May

STATE OF ILL.
COUNTY OF EDGAR SS
I, CHARLES J. BECHER, HEREBY
CERTIFY THAT THIS DOCUMENT WAS PREPARED
UNDER MY DIRECTION IN ACCORDANCE WITH
IND. CODE 36-2-12-11-(D)-(3) AND THE ABOVE
DATA IS GIVEN UNDER MY HAND AND SEAL
THIS 28 DAY OF DEC, 1994 A.D.
Charles J. Becher
INDIANA REGISTERED LAND SURVEYOR NO. 0094
OR _____
UNITED STATES GOVERNMENT AGENCY

TITLE _____

SPACE RESERVED FOR
RECORDING OFFICER
John May
DATE FILED 1/13/95

