

VERMILLION COUNTY, IND.
"MONUMENT RECORD"
 OF

LAND SURVEY MONUMENTS SITUATED IN SECTION 22, TOWNSHIP 15N,
 RANGE 9W, OF THE 2 PRINCIPAL MERIDIAN,
 COUNTY, INDIANA

MONUMENT DESCRIPTION AND REMARKS: Rod w/cap. Found NE corner NE 1/4
Don: Schrieder Engineering Corp. 8/29/30
See: Green Map Cabinet Drawer #1

RECOVERY TIE DRAWING

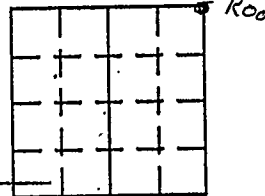

TYPE OF MARKER: ALUM. ROD
 NORTH 2 (NOT TO SCALE)

POINT

55

1" ALUM. ROD W/CAP
 SET IN CONCRETE
 HALF WAY DOWN
 RR EMBANKMENT

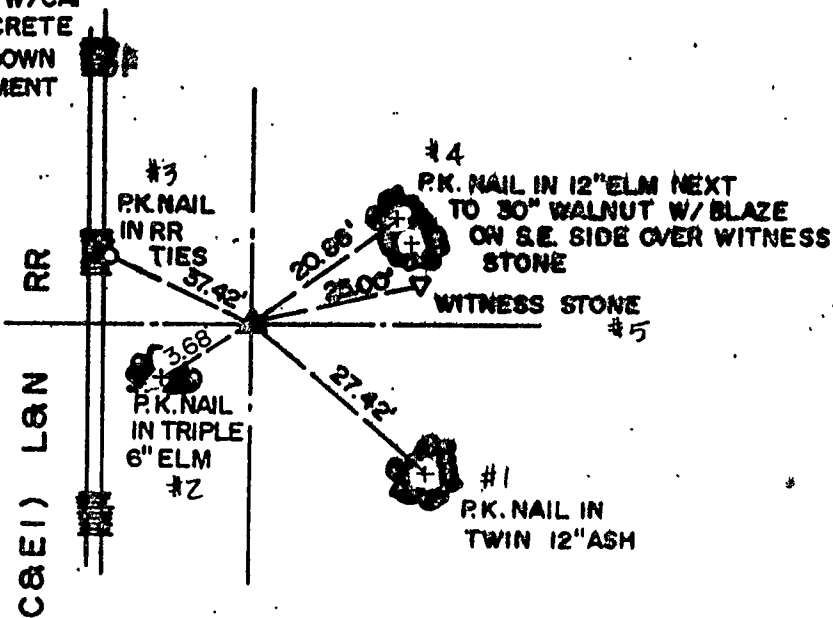

REFERENCE	DISTANCE	DESCRIPTION
1	27.42'	P.K. NAIL IN TWIN 12" ASH

STATE OF _____
 COUNTY OF _____ SS

I, _____, HEREBY
 CERTIFY THAT THIS DOCUMENT WAS PREPARED
 UNDER MY DIRECTION IN ACCORDANCE WITH
 IND. CODE 36-2-12-11-(D)-(3) AND THE ABOVE
 DATA IS GIVEN UNDER MY HAND AND SEAL

THIS _____ DAY OF _____, 19____ A.D.

INDIANA REGISTERED LAND SURVEYOR NO. _____

OR _____
 UNITED STATES GOVERNMENT AGENCY

TITLE

SPACE RESERVED FOR
 RECORDING OFFICER

DATE FILED _____

