

VERMILLION COUNTY, IND. "MONUMENT RECORD" OF

LAND SURVEY MONUMENTS SITUATED IN SECTION 9, TOWNSHIP 16N,
RANGE 9W, OF THE 2 PRINCIPAL MERIDIAN,
COUNTY, INDIANA

MONUMENT DESCRIPTION AND REMARKS: 3/8" Iron Pin Found NE corner
From: 1989 Lietz Cross Section Book Back of page 10 By: John V Major
8/7/89 see: Gray File Cabinet Drawer #2

RECOVERY TIE DRAWING

NORTH
2
(NOT TO SCALE)

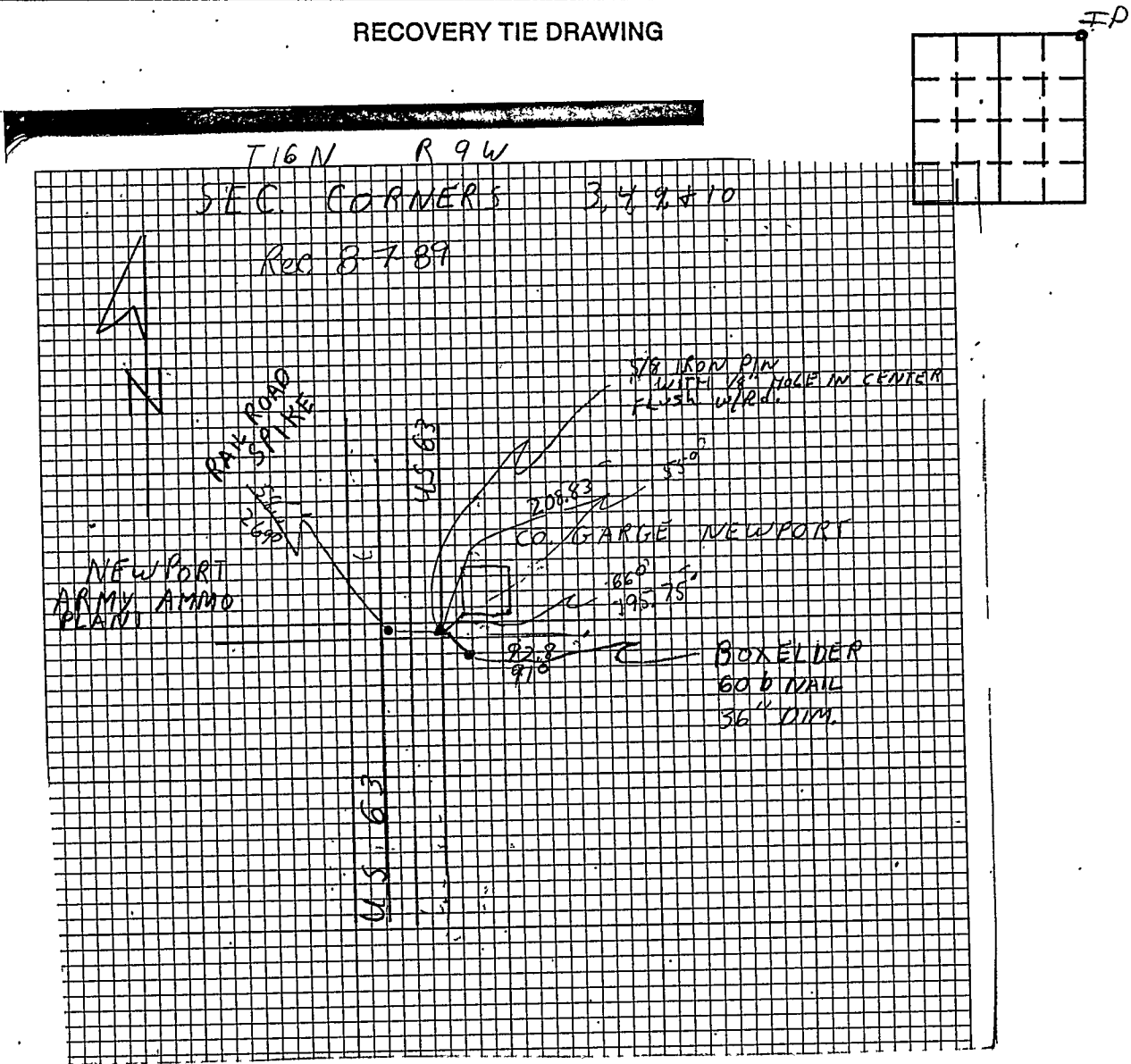

STATE OF _____
COUNTY OF _____ SS

SPACE RESERVED FOR
RECORDING OFFICER

DATE FILED _____

I, _____, HEREBY
CERTIFY THAT THIS DOCUMENT WAS PREPARED
UNDER MY DIRECTION IN ACCORDANCE WITH
IND. CODE 36-2-12-11-(D)-(3) AND THE ABOVE
DATA IS GIVEN UNDER MY HAND AND SEAL

THIS _____ DAY OF _____, 19 _____ A.D.

INDIANA REGISTERED LAND SURVEYOR NO. _____

OR _____
UNITED STATES GOVERNMENT AGENCY

_____ TITLE

