

VERMILLION COUNTY, IND.
"MONUMENT RECORD"
 OF

LAND SURVEY MONUMENTS SITUATED IN SECTION 9, TOWNSHIP 16N,
 RANGE 9W, OF THE 2 PRINCIPAL MERIDIAN,
 COUNTY, INDIANA

MONUMENT DESCRIPTION AND REMARKS: P.I. Pin on Traverse Line SE corner NE 1/4
Map of Boundary Survey Drawn By: W.E. Nash 12/22/42
Project No: 9073 sec: Green Map Cabinet Drawer #1

RECOVERY TIE DRAWING

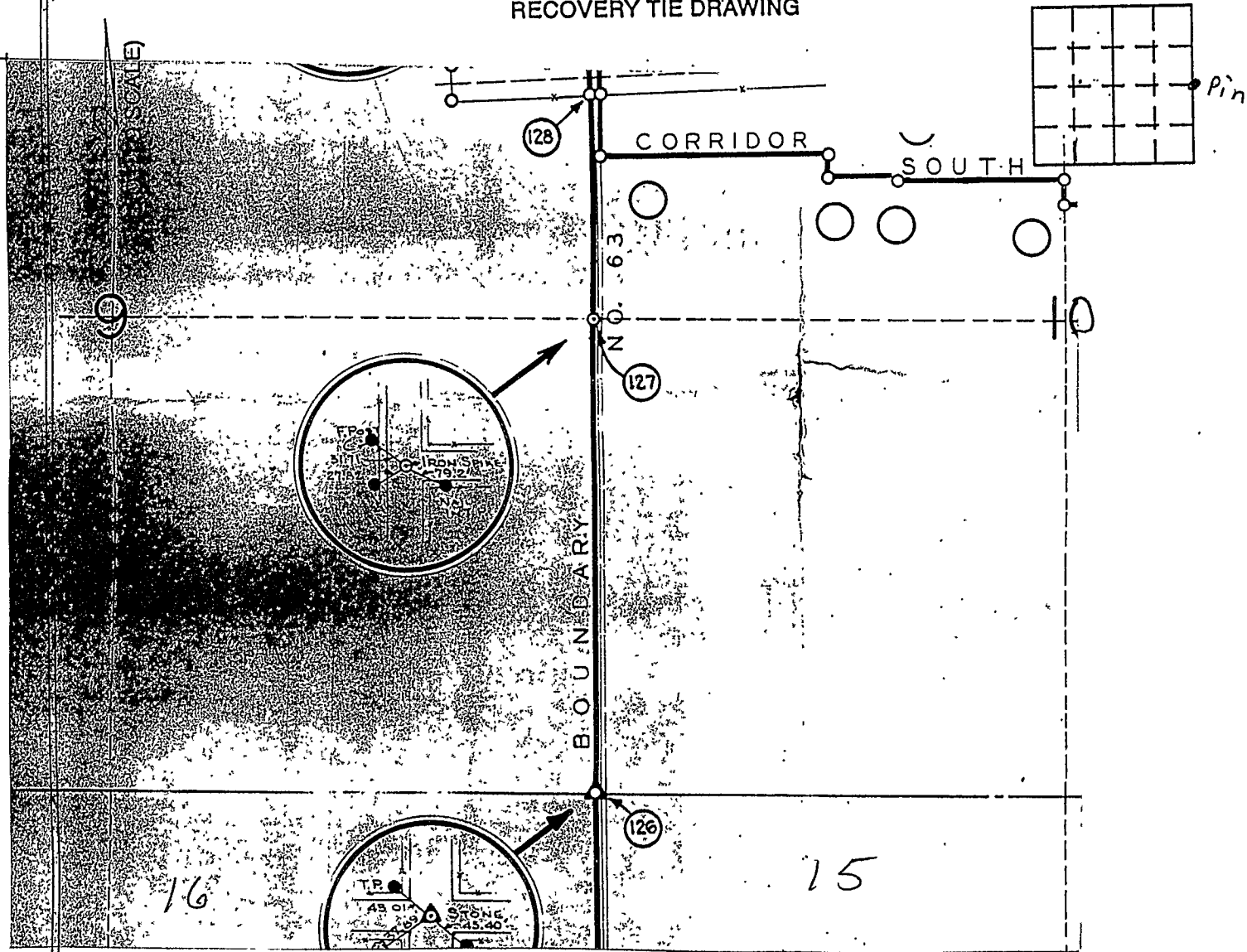

STATE OF _____
 COUNTY OF _____ SS

SPACE RESERVED FOR
 RECORDING OFFICER

I, _____, HEREBY
 CERTIFY THAT THIS DOCUMENT WAS PREPARED
 UNDER MY DIRECTION IN ACCORDANCE WITH
 IND. CODE 36-2-12-11-(D)-(3) AND THE ABOVE
 DATA IS GIVEN UNDER MY HAND AND SEAL

DATE FILED _____

THIS _____ DAY OF _____, 19____ A.D.

