

**VERMILLION COUNTY, IND.
"MONUMENT RECORD"
OF**

LAND SURVEY MONUMENTS SITUATED IN SECTION 10, TOWNSHIP 16 North,
RANGE 9 West, OF THE 2nd PRINCIPAL MERIDIAN, Vermillion,
COUNTY, INDIANA

MONUMENT DESCRIPTION AND REMARKS: West Quarter Corner
set by McClintock

RECOVERY TIE DRAWING

NORTH 2
(NOT TO SCALE)

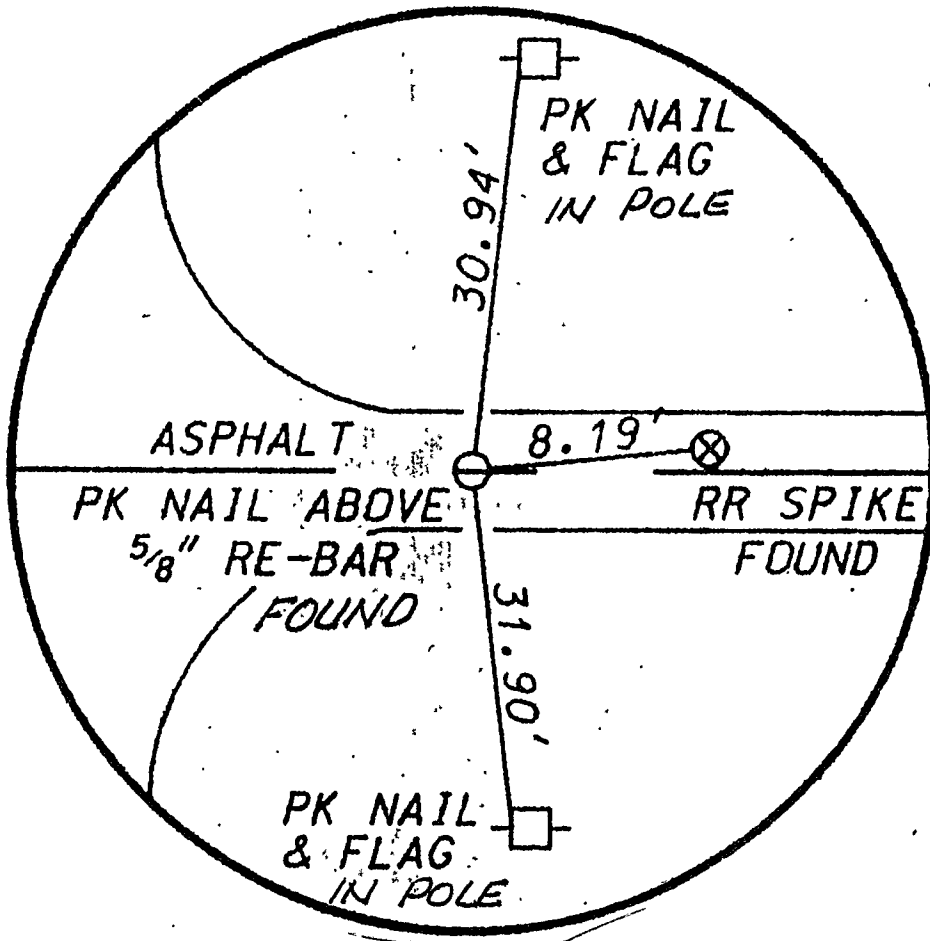
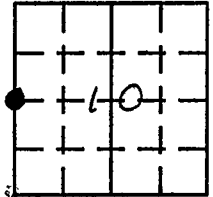

STATE OF Indiana
COUNTY OF Vermillion SS

I, _____, HEREBY
CERTIFY THAT THIS DOCUMENT WAS PREPARED
UNDER MY DIRECTION IN ACCORDANCE WITH
IND. CODE 36-2-12-11-(D)-(3) AND THE ABOVE
DATA IS GIVEN UNDER MY HAND AND SEAL

THIS 3rd DAY OF March, 1997 A.D.

Robert L. McClintock
INDIANA REGISTERED LAND SURVEYOR NO. S0082

OR _____
UNITED STATES GOVERNMENT AGENCY

_____ TITLE

SPACE RESERVED FOR
RECORDING OFFICER

[Signature]
DATE FILED 3/12/97

