

VERMILLION COUNTY, IND.
"MONUMENT RECORD"

OF

17

LAND SURVEY MONUMENTS SITUATED IN SECTION 27, TOWNSHIP N

RANGE 9W, OF THE 2ND PRINCIPAL MERIDIAN, VERMILLION

COUNTY, INDIANA

MONUMENT DESCRIPTION AND REMARKS: FOUND PR NAME A-1
W 1/4 CORNER

RECOVERY TIE DRAWING

NORTH
(NOT TO SCALE)

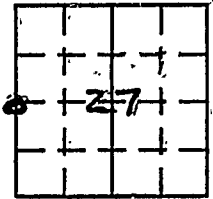
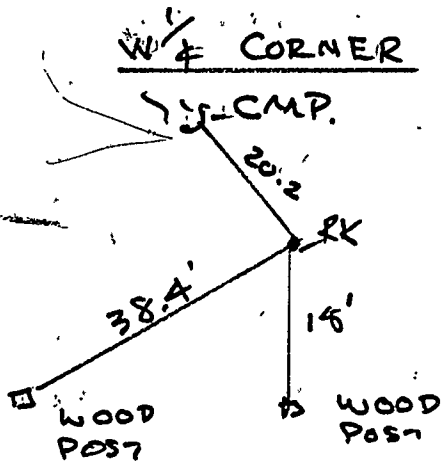

SURVEY RECORDED IN
SURVEYOR'S OFFICE
VERMILLION COUNTY INDIANA

MONUMENT RECORD BOOK # 1

PAGE # 17 DATE 1/13/95

CO. SURVEYOR John May

STATE OF IL.
COUNTY OF EDGAR SS

I, CHARLES J. BECHER, HEREBY
CERTIFY THAT THIS DOCUMENT WAS PREPARED
UNDER MY DIRECTION IN ACCORDANCE WITH
IND. CODE 36-2-12-11-(D)-(3) AND THE ABOVE
DATA IS GIVEN UNDER MY HAND AND SEAL

THIS 28 DAY OF Dec, 19 94 A.D.

Charles J. Becher
INDIANA REGISTERED LAND SURVEYOR NO. 0094

OR
UNITED STATES GOVERNMENT AGENCY

TITLE

SPACE RESERVED FOR
RECORDING OFFICER

John May

DATE FILED 1/13/95

