

# VERMILLION COUNTY, IND. "MONUMENT RECORD"

OF

LAND SURVEY MONUMENTS SITUATED IN SECTION 8, TOWNSHIP 19N,  
RANGE 9W, OF THE 2 PRINCIPAL MERIDIAN,  
COUNTY, INDIANA

MONUMENT DESCRIPTION AND REMARKS: 1" Pen in 8"x8" Box Found SE corner  
From: 1989 Lietz Cross Section Book Back of pg 29  
By: John V. Major 12/7/89 see: Gray File Cabinet 2<sup>nd</sup> Drawer

RECOVERY TIE DRAWING

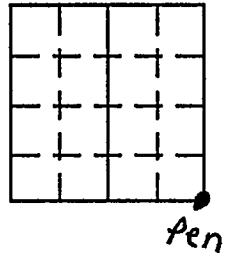
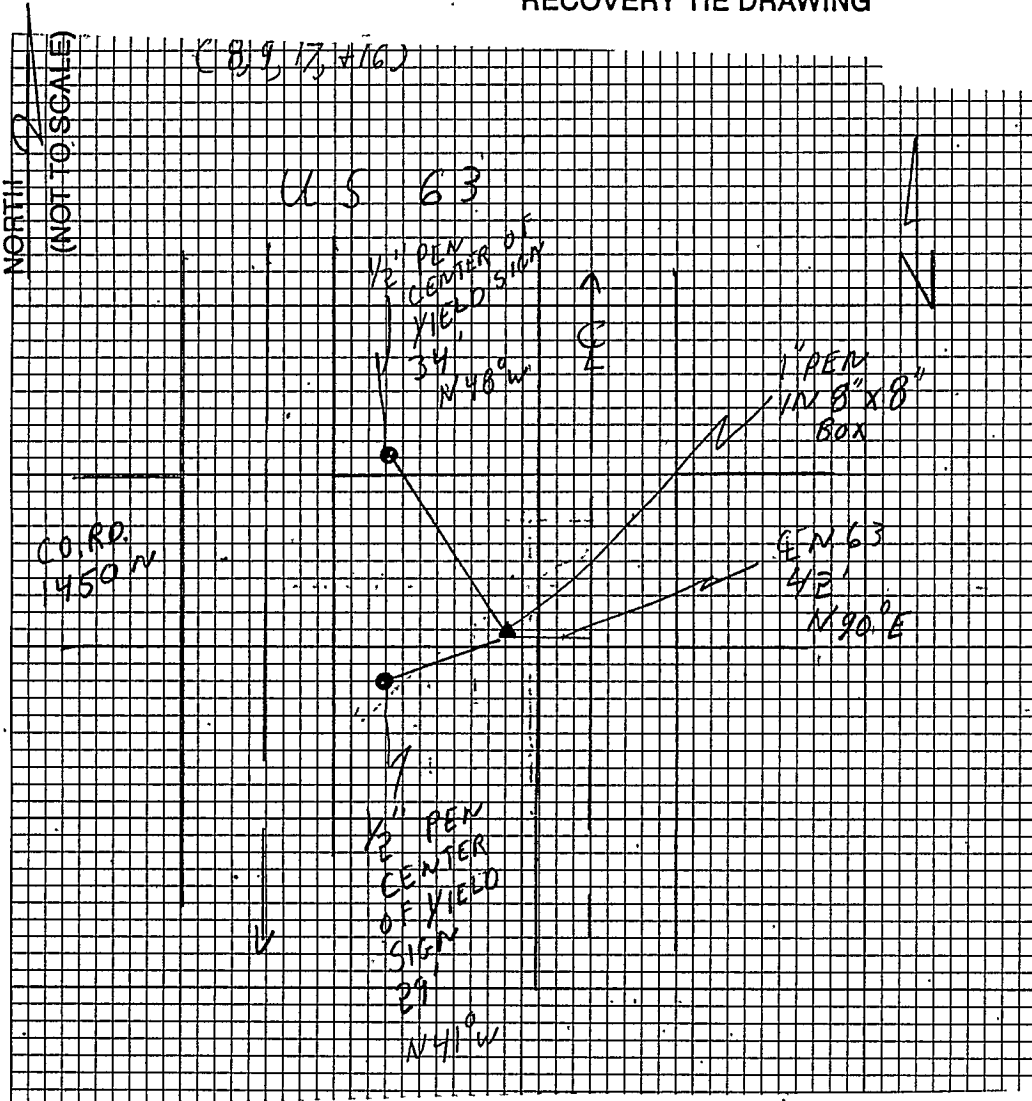

STATE OF \_\_\_\_\_  
COUNTY OF \_\_\_\_\_ SS.

SPACE RESERVED FOR  
RECORDING OFFICER

I, \_\_\_\_\_, HEREBY  
CERTIFY THAT THIS DOCUMENT WAS PREPARED  
UNDER MY DIRECTION IN ACCORDANCE WITH  
IND. CODE 36-2-12-11-(D)-(3) AND THE ABOVE  
DATA IS GIVEN UNDER MY HAND AND SEAL

DATE FILED \_\_\_\_\_

THIS \_\_\_\_\_ DAY OF \_\_\_\_\_, 19\_\_\_\_ A.D.

