

# SECTION CORNER RECORD

ND6

## VERMILLION COUNTY SURVEYOR'S OFFICE

State Plane grid coordinates NAD83 (2011):

North: 1709459.30 East: 2844138.19 (U.S. survey feet)

Type of monument: VCS Monument (3-inch diameter steel disk in concrete)

Depth: One inch below adjacent road surface

Indiana tie card references:

IN02\_T17NR9W06\_80 IN02\_T17NR9W05\_72

IN02\_T17NR9W07\_08 IN02\_T17NR9W08\_00

### CORNER WITNESS DETAIL

SCALE 1" = 50'

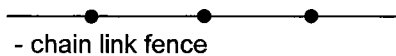

- A - Mag nail set in S side pwp 2' a.g., 34.31'
- B - Mag nail set in W side pwp, 2' a.g., 30.59'
- C - Southwestern bolt in fire hydrant, 49.39'

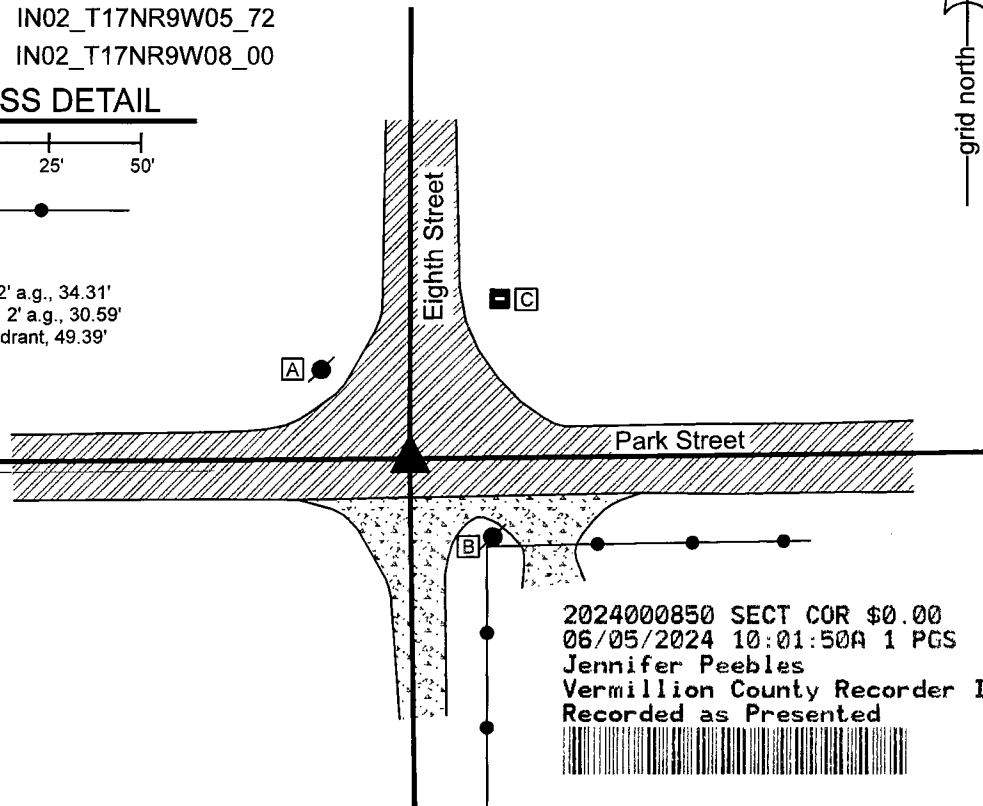

2024000850 SECT COR \$0.00  
06/05/2024 10:01:50A 1 PGS  
Jennifer Peebles  
Vermillion County Recorder IN  
Recorded as Presented



The VCS monument was set in place of a rebar and iron pipe found.

An undated document labelled 'Vermillion County, Ind. Monument Record' shows the corner as 'Stone.' This document appears to be a copy of part of Richardson's Addition to Cayuga, dated October 8&9, 1903. No other references to the 'stone' were found in the public records. Numerous surveys, including surveys recorded as Instruments 200603194, 200800810 and 2020001834, as well as the plat of McLain's Addition to Cayuga, recorded in Survey Record 1, page 543, call for an iron pin at the corners.

This corner was excavated on May 2, 2023. Prior to excavation, a 1/2-inch diameter rebar was found at 4 inches deep in a hole in the asphalt at the intersection of Park Street and Eighth Street. Excavation revealed a 1-inch diameter iron pipe found at 16 inches deep. The 1/2-inch rebar had been driven along the north edge of the iron pipe. Excavation of an area 5 feet N-S by 5 feet E-W revealed no further evidence of the corner. Clear evidence of previous disruption of the old road bed was observed in the east half of the excavation area. The bottom of the road bed in the west side of the excavation was found at 20 inches below grade. The bottom of the road bed in the east side was found at 26 inches and it was obvious that some form of trench had been previously excavated there. The stone called for on the plat of Richardson's Addition was not found. The iron pipe, being the deepest and oldest evidence found, was held as the corner. Both the rebar and iron pipe were removed during excavation and replaced with a steel disk set in concrete with spiral spikes.

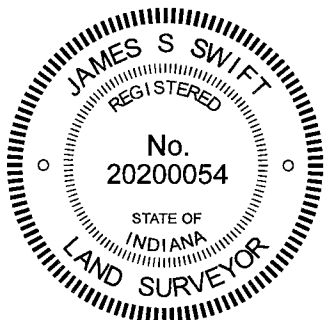

*Ronald A. Mack*  
Ronald A. Mack, County Surveyor

*James S. Swift*  
James S. Swift, IN LS 20200054  
July 25, 2023

Eugene Township

Section 6 T17N, R9W	Section 5 T17N, R9W
Section 7 T17N, R9W	Section 8 T17N, R9W